

879-880-881 M6 Series

Curve magnetiche, Tab & Bevel / Magnetic, Tab & Bevel corner tracks / Kurvenführungen Magnet, Tab & Bevel Version

Materiale / Material / Materialien:
UHMW-PE riciclato / Recycling UHMW-PE
Rezykliertes UHMW-PE
BluLub Guide / Guides / Gleitprofile

879-880-881 M6 Series

Chain Reference	879 M - K325	880 M - K325	880 M - K330	881 M - K325	881 M - K330	Delivery:	Easy	Standard
-----------------	--------------	--------------	--------------	--------------	--------------	-----------	------	----------

Curve Basic Width = 100 mm; Pitch = 85 mm

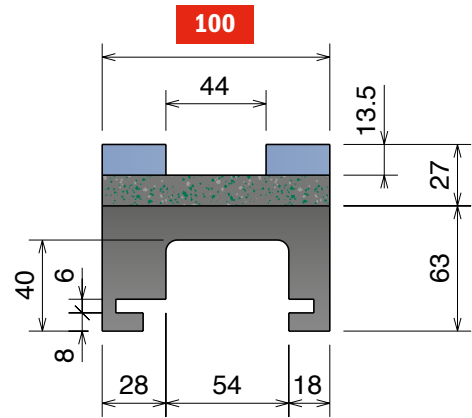
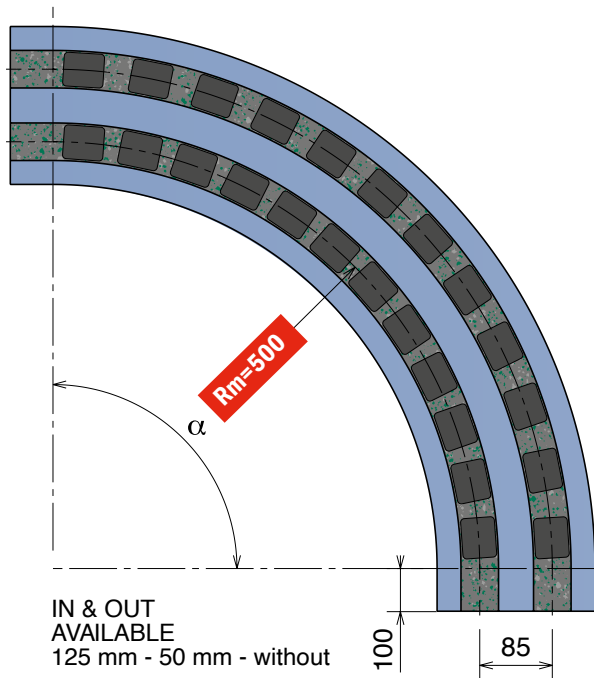

SINGLE TRACK

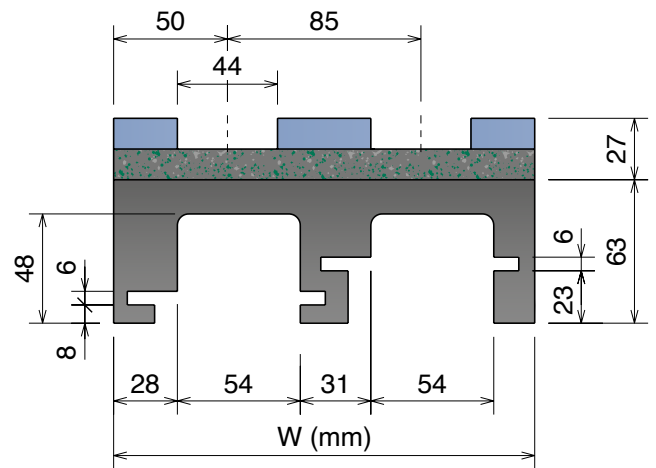

MULTI TRACK



Available in
BluLub®

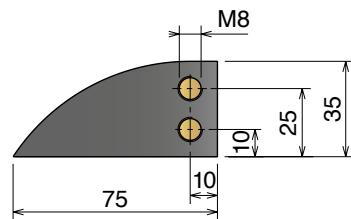

RS complete curve

MAGNETIC SYSTEM

Solid curve in different materials available on request.

α 15°	α 30°	α 45°	α 60°	α 75°	α 90°	Tracks	W	Material
8011114RS	80111214RS	80111314RS	80111414RS	80111514RS	80111614RS	1	100	<p>Standard codes are for RS for RS^H add "H" for RS^C add "C"</p>
80111124RS	80111224RS	80111324RS	80111424RS	80111524RS	80111624RS	2	185	
80111134RS	80111234RS	80111334RS	80111434RS	80111534RS	80111634RS	3	270	
80111144RS	80111244RS	80111344RS	80111444RS	80111544RS	80111644RS	4	355	
80111154RS	80111254RS	80111354RS	80111454RS	80111554RS	80111654RS	5	440	
80111164RS	80111264RS	80111364RS	80111464RS	80111564RS	80111664RS	6	525	
80111174RS	80111274RS	80111374RS	80111474RS	80111574RS	80111674RS	7	610	
80111184RS	80111284RS	80111384RS	80111484RS	80111584RS	80111684RS	8	695	

Guides replacement kit

α 15°	α 30°	α 45°	α 60°	α 75°	α 90°	Tracks	W	Material
8011114RS-KIT	80111214RS-KIT	80111314RS-KIT	80111414RS-KIT	80111514RS-KIT	80111614RS-KIT	1	100	<p>Standard codes are for RS Kit for RS^H Kit replace "RS" with "RSH" for RS^C Kit replace "RS" with "RSC"</p>
80111124RS-KIT	80111224RS-KIT	80111324RS-KIT	80111424RS-KIT	80111524RS-KIT	80111624RS-KIT	2	185	
80111134RS-KIT	80111234RS-KIT	80111334RS-KIT	80111434RS-KIT	80111534RS-KIT	80111634RS-KIT	3	270	
80111144RS-KIT	80111244RS-KIT	80111344RS-KIT	80111444RS-KIT	80111544RS-KIT	80111644RS-KIT	4	355	
80111154RS-KIT	80111254RS-KIT	80111354RS-KIT	80111454RS-KIT	80111554RS-KIT	80111654RS-KIT	5	440	
80111164RS-KIT	80111264RS-KIT	80111364RS-KIT	80111464RS-KIT	80111564RS-KIT	80111664RS-KIT	6	525	
80111174RS-KIT	80111274RS-KIT	80111374RS-KIT	80111474RS-KIT	80111574RS-KIT	80111674RS-KIT	7	610	
80111184RS-KIT	80111284RS-KIT	80111384RS-KIT	80111484RS-KIT	80111584RS-KIT	80111684RS-KIT	8	695	

Images may differ from the actual product and are for illustrative purposes only.

Curve magnetiche, Tab & Bevel / Magnetic, Tab & Bevel corner tracks / Kurvenführungen Magnet, Tab & Bevel Version

879-880-881 M7 Series

Chain Reference 879 M - K325 880 M - K325 880 M - K330 881 M - K325 881 M - K330

Curve Basic Width = 100 mm; Pitch = 85 mm

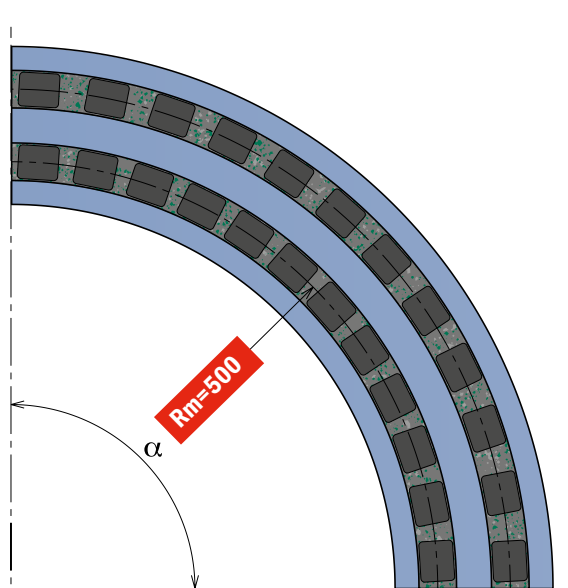

IN & OUT
 AVAILABLE ALSO
 125 mm - 100 mm - 50 mm



Available in
 BluLub®

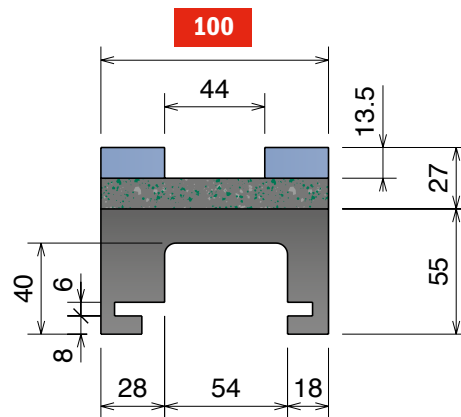
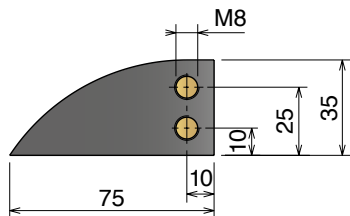

SINGLE TRACK

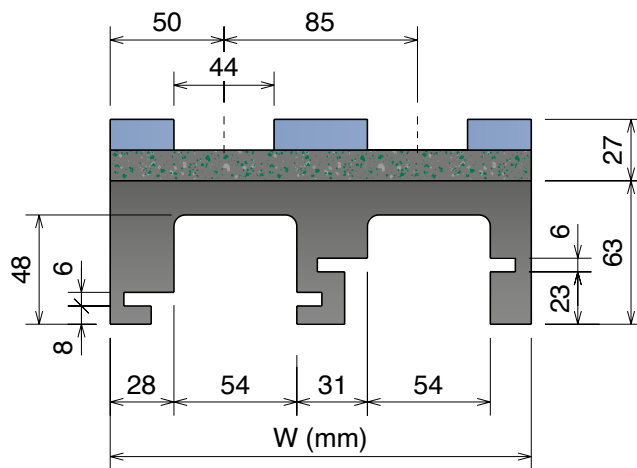

MULTI TRACK

RS complete curve

MAGNETIC SYSTEM

Solid curve in different materials available on request.

α 15°	α 30°	α 45°	α 60°	α 75°	α 90°	Tracks	W	Material
80111110RS	80111210RS	80111310RS	80111410RS	80111510RS	80111610RS	1	100	<p>Standard codes are for RS for RS^H add "H" for RS^C add "C"</p>
80111120RS	80111220RS	80111320RS	80111420RS	80111520RS	80111620RS	2	185	
80111130RS	80111230RS	80111330RS	80111430RS	80111530RS	80111630RS	3	270	
80111140RS	80111240RS	80111340RS	80111440RS	80111540RS	80111640RS	4	355	
80111150RS	80111250RS	80111350RS	80111450RS	80111550RS	80111650RS	5	440	
80111160RS	80111260RS	80111360RS	80111460RS	80111560RS	80111660RS	6	525	
80111170RS	80111270RS	80111370RS	80111470RS	80111570RS	80111670RS	7	610	
80111180RS	80111280RS	80111380RS	80111480RS	80111580RS	80111680RS	8	695	

Guides replacement kit

α 15°	α 30°	α 45°	α 60°	α 75°	α 90°	Tracks	W	Material
80111110RS-KIT	80111210RS-KIT	80111310RS-KIT	80111410RS-KIT	80111510RS-KIT	80111610RS-KIT	1	100	<p>Standard codes are for RS Kit for RS^H Kit replace "RS" with "RS^H" for RS^C Kit replace "RS" with "RS^C"</p>
80111120RS-KIT	80111220RS-KIT	80111320RS-KIT	80111420RS-KIT	80111520RS-KIT	80111620RS-KIT	2	185	
80111130RS-KIT	80111230RS-KIT	80111330RS-KIT	80111430RS-KIT	80111530RS-KIT	80111630RS-KIT	3	270	
80111140RS-KIT	80111240RS-KIT	80111340RS-KIT	80111440RS-KIT	80111540RS-KIT	80111640RS-KIT	4	355	
80111150RS-KIT	80111250RS-KIT	80111350RS-KIT	80111450RS-KIT	80111550RS-KIT	80111650RS-KIT	5	440	
80111160RS-KIT	80111260RS-KIT	80111360RS-KIT	80111460RS-KIT	80111560RS-KIT	80111660RS-KIT	6	525	
80111170RS-KIT	80111270RS-KIT	80111370RS-KIT	80111470RS-KIT	80111570RS-KIT	80111670RS-KIT	7	610	
80111180RS-KIT	80111280RS-KIT	80111380RS-KIT	80111480RS-KIT	80111580RS-KIT	80111680RS-KIT	8	695	

879-880-881 M10 Series

Curve magnetiche, Tab & Bevel / Magnetic, Tab & Bevel corner tracks / Kurvenführungen Magnet, Tab & Bevel Version

Materiale / Material / Materialien:
UHMW-PE riciclato / Recycling UHMW-PE
Rezykliertes UHMW-PE
BluLub Guide / Guides / Gleitprofile

879-880-881 M10 Series

Chain Reference	879 M - K325	880 M - K325	880 M - K330	881 M - K325	881 M - K330
-----------------	--------------	--------------	--------------	--------------	--------------

Curve Basic Width = 110 mm; Pitch = 85 mm

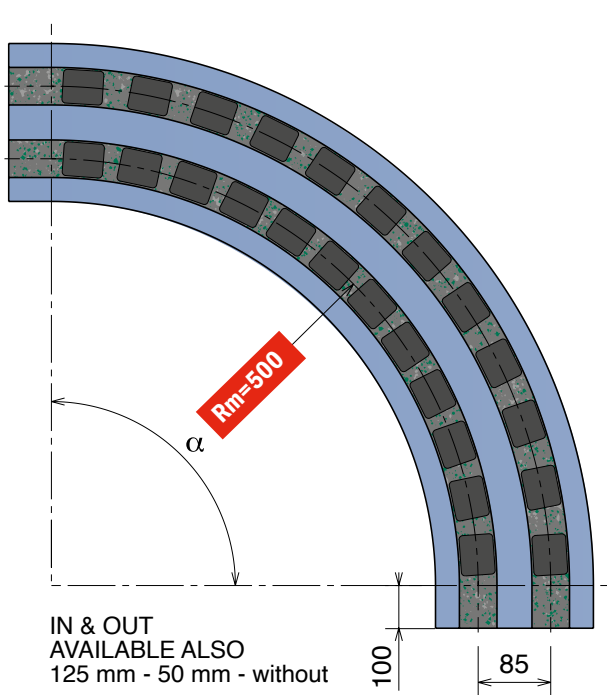

IN & OUT AVAILABLE ALSO
125 mm - 50 mm - without



Available in
BluLub®

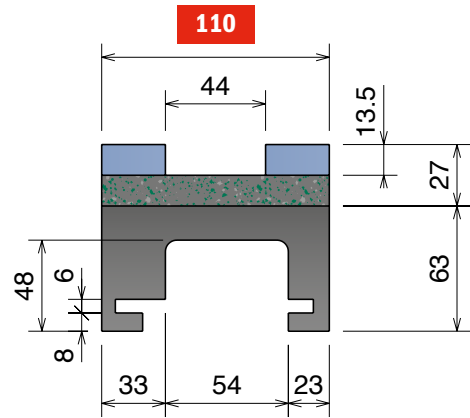
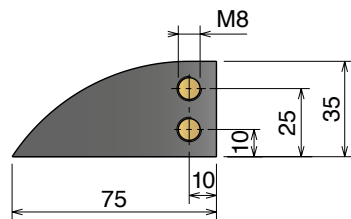

SINGLE TRACK

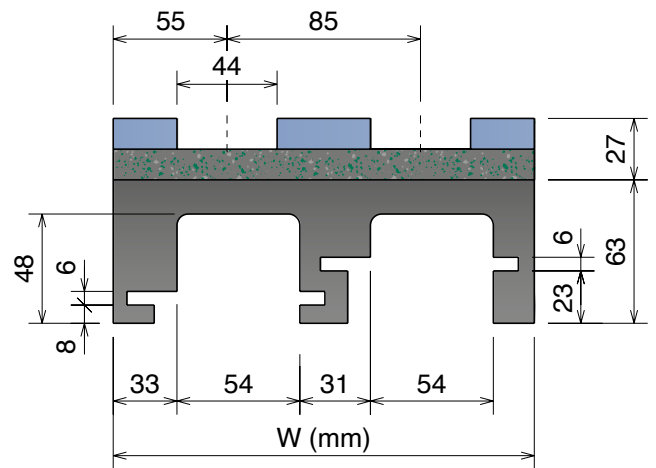

MULTI TRACK

RS complete curve

MAGNETIC SYSTEM

Solid curve in different materials available on request.

α 15°	α 30°	α 45°	α 60°	α 75°	α 90°	Tracks	W	Material
8111114RS	81111214RS	81111314RS	81111414RS	81111514RS	81111614RS	1	110	<p>Standard codes are for RS</p> <p>for RS^H add "H"</p> <p>for RS^C add "C"</p>
81111124RS	81111224RS	81111324RS	81111424RS	81111524RS	81111624RS	2	195	
81111134RS	81111234RS	81111334RS	81111434RS	81111534RS	81111634RS	3	280	
81111144RS	81111244RS	81111344RS	81111444RS	81111544RS	81111644RS	4	365	
81111154RS	81111254RS	81111354RS	81111454RS	81111554RS	81111654RS	5	450	
81111164RS	81111264RS	81111364RS	81111464RS	81111564RS	81111664RS	6	535	
81111174RS	81111274RS	81111374RS	81111474RS	81111574RS	81111674RS	7	620	
81111184RS	81111284RS	81111384RS	81111484RS	81111584RS	81111684RS	8	705	

Guides replacement kit

α 15°	α 30°	α 45°	α 60°	α 75°	α 90°	Tracks	W	Material
8111114RS-KIT	81111214RS-KIT	81111314RS-KIT	81111414RS-KIT	81111514RS-KIT	81111614RS-KIT	1	110	<p>Standard codes are for RS Kit</p> <p>for RS^H Kit replace "RS" with "RSH"</p> <p>for RS^C Kit replace "RS" with "RSC"</p>
81111124RS-KIT	81111224RS-KIT	81111324RS-KIT	81111424RS-KIT	81111524RS-KIT	81111624RS-KIT	2	195	
81111134RS-KIT	81111234RS-KIT	81111334RS-KIT	81111434RS-KIT	81111534RS-KIT	81111634RS-KIT	3	280	
81111144RS-KIT	81111244RS-KIT	81111344RS-KIT	81111444RS-KIT	81111544RS-KIT	81111644RS-KIT	4	365	
81111154RS-KIT	81111254RS-KIT	81111354RS-KIT	81111454RS-KIT	81111554RS-KIT	81111654RS-KIT	5	450	
81111164RS-KIT	81111264RS-KIT	81111364RS-KIT	81111464RS-KIT	81111564RS-KIT	81111664RS-KIT	6	535	
81111174RS-KIT	81111274RS-KIT	81111374RS-KIT	81111474RS-KIT	81111574RS-KIT	81111674RS-KIT	7	620	
81111184RS-KIT	81111284RS-KIT	81111384RS-KIT	81111484RS-KIT	81111584RS-KIT	81111684RS-KIT	8	705	

Images may differ from the actual product and are for illustrative purposes only.

Curve magnetiche, Tab & Bevel / Magnetic, Tab & Bevel corner tracks / Kurvenführungen Magnet, Tab & Bevel Version

879-880-881 M4 Series

Chain Reference 879 M - K325 880 M - K325 880 M - K330 881 M - K325 881 M - K330

Curve Basic Width = 111 mm; Pitch = 85 mm

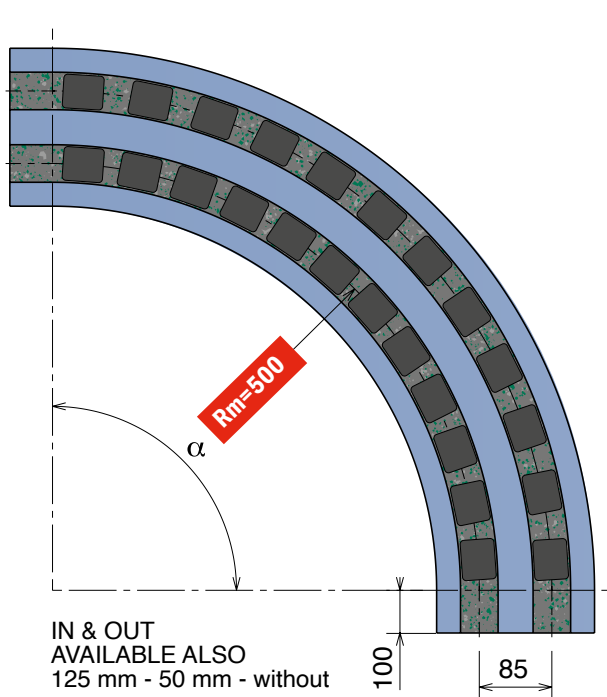

Available in **BluLub®**

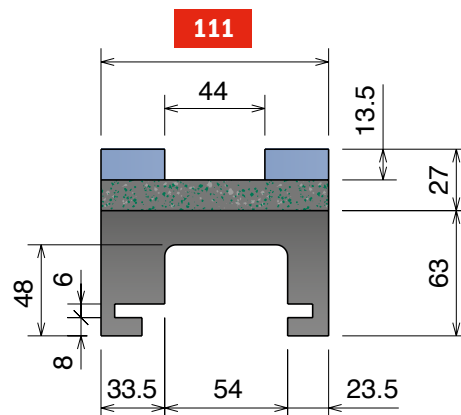
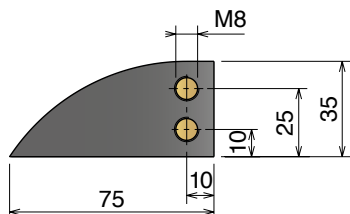

SINGLE TRACK

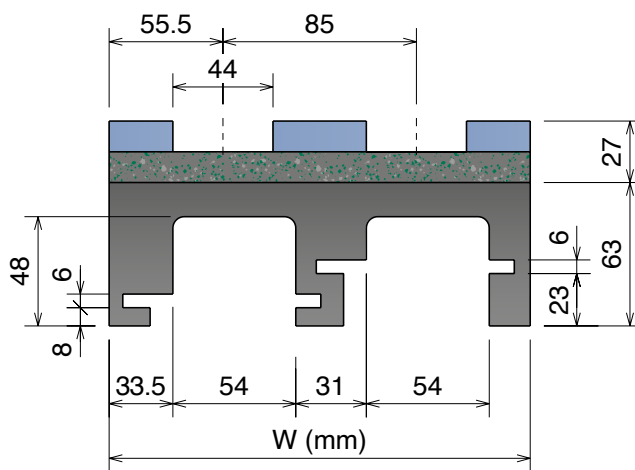

MULTI TRACK

RS complete curve

MAGNETIC SYSTEM

Solid curve in different materials available on request.

α 15°	α 30°	α 45°	α 60°	α 75°	α 90°	Tracks	W	Material
81211114RS	81211214RS	81211314RS	81211414RS	81211514RS	81211614RS	1	111	<p>Standard codes are for RS</p> <p>for RS^H add "H"</p> <p>for RS^C add "C"</p>
81211124RS	81211224RS	81211324RS	81211424RS	81211524RS	81211624RS	2	196	
81211134RS	81211234RS	81211334RS	81211434RS	81211534RS	81211634RS	3	281	
81211144RS	81211244RS	81211344RS	81211444RS	81211544RS	81211644RS	4	366	
81211154RS	81211254RS	81211354RS	81211454RS	81211554RS	81211654RS	5	451	
81211164RS	81211264RS	81211364RS	81211464RS	81211564RS	81211664RS	6	536	
81211174RS	81211274RS	81211374RS	81211474RS	81211574RS	81211674RS	7	621	
81211184RS	81211284RS	81211384RS	81211484RS	81211584RS	81211684RS	8	706	

Guides replacement kit

α 15°	α 30°	α 45°	α 60°	α 75°	α 90°	Tracks	W	Material
81211114RS-KIT	81211214RS-KIT	81211314RS-KIT	81211414RS-KIT	81211514RS-KIT	81211614RS-KIT	1	111	<p>Standard codes are for RS Kit</p> <p>for RS^H Kit replace "RS" with "RS^H"</p> <p>for RS^C Kit replace "RS" with "RS^C"</p>
81211124RS-KIT	81211224RS-KIT	81211324RS-KIT	81211424RS-KIT	81211524RS-KIT	81211624RS-KIT	2	196	
81211134RS-KIT	81211234RS-KIT	81211334RS-KIT	81211434RS-KIT	81211534RS-KIT	81211634RS-KIT	3	281	
81211144RS-KIT	81211244RS-KIT	81211344RS-KIT	81211444RS-KIT	81211544RS-KIT	81211644RS-KIT	4	366	
81211154RS-KIT	81211254RS-KIT	81211354RS-KIT	81211454RS-KIT	81211554RS-KIT	81211654RS-KIT	5	451	
81211164RS-KIT	81211264RS-KIT	81211364RS-KIT	81211464RS-KIT	81211564RS-KIT	81211664RS-KIT	6	536	
81211174RS-KIT	81211274RS-KIT	81211374RS-KIT	81211474RS-KIT	81211574RS-KIT	81211674RS-KIT	7	621	
81211184RS-KIT	81211284RS-KIT	81211384RS-KIT	81211484RS-KIT	81211584RS-KIT	81211684RS-KIT	8	706	

879-880-881 M1 Series

Curve magnetiche, Tab & Bevel / Magnetic, Tab & Bevel corner tracks / Kurvenführungen Magnet, Tab & Bevel Version

Materiale / Material / Materialien:
UHMW-PE riciclato / Recycling UHMW-PE
Rezykliertes UHMW-PE
BluLub Guide / Guides / Gleitprofile

879-880-881 M1 Series

Chain Reference	879 M - K325	880 M - K325	880 M - K330	881 M - K325	881 M - K330
-----------------	--------------	--------------	--------------	--------------	--------------

Curve Basic Width = 100 mm; Pitch = 89 mm

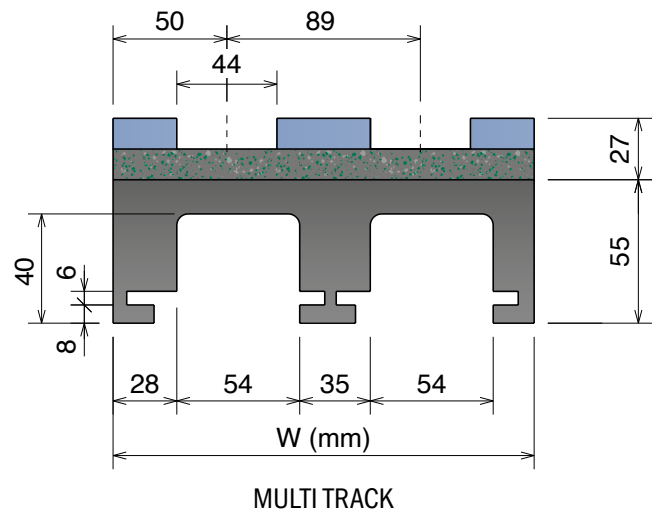
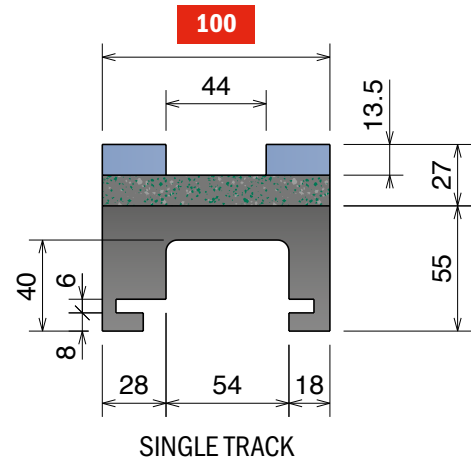
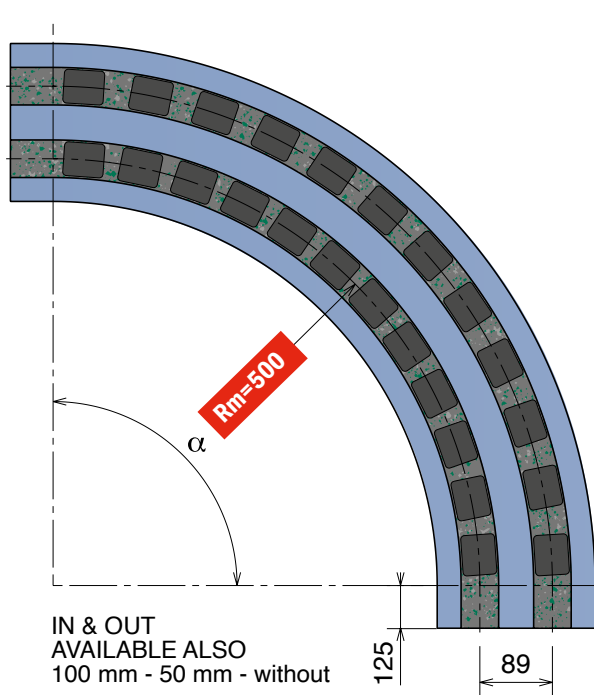

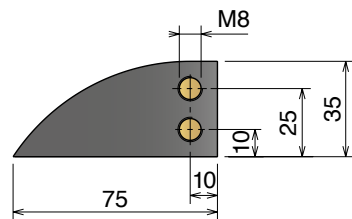

Available in
BluLub®



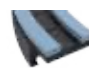
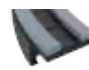

RS complete curve

MAGNETIC SYSTEM

Solid curve in different materials available on request.

α 15°	α 30°	α 45°	α 60°	α 75°	α 90°	Tracks	W	Material
83011115RS	83011215RS	83011315RS	83011415RS	83011515RS	83011615RS	1	100	 Standard codes are for RS  for RS^H add "H"  for RS^C add "C"
83011125RS	83011225RS	83011325RS	83011425RS	83011525RS	83011625RS	2	189	
83011135RS	83011235RS	83011335RS	83011435RS	83011535RS	83011635RS	3	278	
83011145RS	83011245RS	83011345RS	83011445RS	83011545RS	83011645RS	4	367	
83011155RS	83011255RS	83011355RS	83011455RS	83011555RS	83011655RS	5	456	
83011165RS	83011265RS	83011365RS	83011465RS	83011565RS	83011665RS	6	545	
83011175RS	83011275RS	83011375RS	83011475RS	83011575RS	83011675RS	7	634	
83011185RS	83011285RS	83011385RS	83011485RS	83011585RS	83011685RS	8	723	

Guides replacement kit

α 15°	α 30°	α 45°	α 60°	α 75°	α 90°	Tracks	W	Material
83011115RS-KIT	83011215RS-KIT	83011315RS-KIT	83011415RS-KIT	83011515RS-KIT	83011615RS-KIT	1	100	 Standard codes are for RS Kit  for RS^H Kit replace "RS" with "RS ^H "  for RS^C Kit replace "RS" with "RS ^C "
83011125RS-KIT	83011225RS-KIT	83011325RS-KIT	83011425RS-KIT	83011525RS-KIT	83011625RS-KIT	2	189	
83011135RS-KIT	83011235RS-KIT	83011335RS-KIT	83011435RS-KIT	83011535RS-KIT	83011635RS-KIT	3	278	
83011145RS-KIT	83011245RS-KIT	83011345RS-KIT	83011445RS-KIT	83011545RS-KIT	83011645RS-KIT	4	367	
83011155RS-KIT	83011255RS-KIT	83011355RS-KIT	83011455RS-KIT	83011555RS-KIT	83011655RS-KIT	5	456	
83011165RS-KIT	83011265RS-KIT	83011365RS-KIT	83011465RS-KIT	83011565RS-KIT	83011665RS-KIT	6	545	
83011175RS-KIT	83011275RS-KIT	83011375RS-KIT	83011475RS-KIT	83011575RS-KIT	83011675RS-KIT	7	634	
83011185RS-KIT	83011285RS-KIT	83011385RS-KIT	83011485RS-KIT	83011585RS-KIT	83011685RS-KIT	8	723	

Images may differ from the actual product and are for illustrative purposes only.

879-880-881 M5 A/C/D Series

Chain Reference	879 M - K325	880 M - K325	880 M - K330	881 M - K325	881 M - K330
-----------------	--------------	--------------	--------------	--------------	--------------

Curve Basic Width = 100 mm

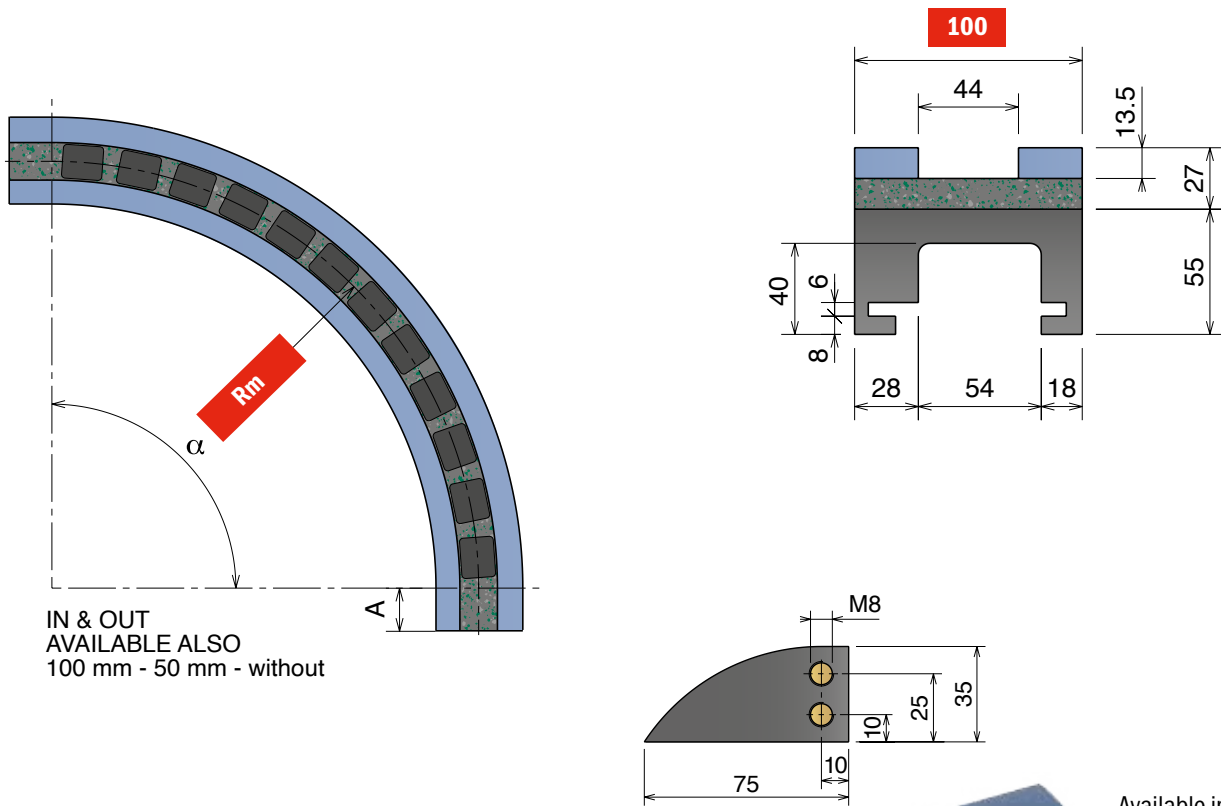

IN & OUT
 AVAILABLE ALSO
 100 mm - 50 mm - without



Available in
BluLub®

RS complete curve

M5A Series - Rm 680

α 15°	α 30°	α 45°	α 60°	α 75°	α 90°	Tracks	W	A	Rm
80315114RS	80315214RS	80315314RS	80315414RS	80315514RS	80315614RS	1	100	100	680

M5C Series - Rm 860

α 15°	α 30°	α 45°	α 60°	α 75°	α 90°	Tracks	W	A	Rm
80318115RS	80318215RS	80318315RS	80318415RS	80318515RS	80318615RS	1	100	125	860

M5D Series - Rm 1000

α 15°	α 30°	α 45°	α 60°	α 75°	α 90°	Tracks	W	A	Rm
80319110RS	80319210RS	80319310RS	80319410RS	80319510RS	80319610RS	1	100	0	1000

MAGNETIC SYSTEM

Solid curve in different materials available on request.



Standard codes are for **RS**



for **RS^H** add "H"



for **RS^C** add "C"

Guides replacement kit

M5A Series - Rm 680

α 15°	α 30°	α 45°	α 60°	α 75°	α 90°	Tracks	W	A	Rm
80315114RS-KIT	80315214RS-KIT	80315314RS-KIT	80315414RS-KIT	80315514RS-KIT	80315614RS-KIT	1	100	100	680

M5C Series - Rm 860

α 15°	α 30°	α 45°	α 60°	α 75°	α 90°	Tracks	W	A	Rm
80318115RS-KIT	80318215RS-KIT	80318315RS-KIT	80318415RS-KIT	80318515RS-KIT	80318615RS-KIT	1	100	125	860

M5D Series - Rm 1000

α 15°	α 30°	α 45°	α 60°	α 75°	α 90°	Tracks	W	A	Rm
80319110RS-KIT	80319210RS-KIT	80319310RS-KIT	80319410RS-KIT	80319510RS-KIT	80319610RS-KIT	1	100	0	1000



Standard codes are for **RS Kit**



for **RS^H Kit** replace "RS" with "RS^H"



for **RS^C Kit** replace "RS" with "RS^C"

879-880-881 M8 Series

Curve magnetic, Tab & Bevel / Magnetic, Tab & Bevel corner tracks / Kurvenführungen Magnet, Tab & Bevel Version

Materiale / Material / Materialien:
UHMW-PE riciclato / Recycling UHMW-PE
Rezykliertes UHMW-PE
BluLub Guide / Guides / Gleitprofile

879-880-881 M8 Series

Chain Reference	879 M - K325	880 M - K325	880 M - K330	881 M - K325	881 M - K330
-----------------	--------------	--------------	--------------	--------------	--------------

Curve Basic Width = 100 mm; Pitch = 85 mm

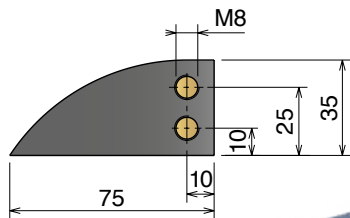
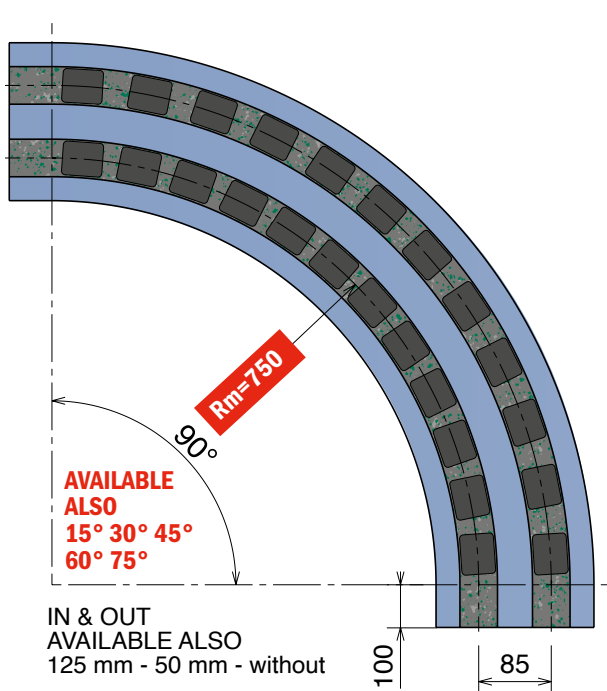

Available in **BluLub®**

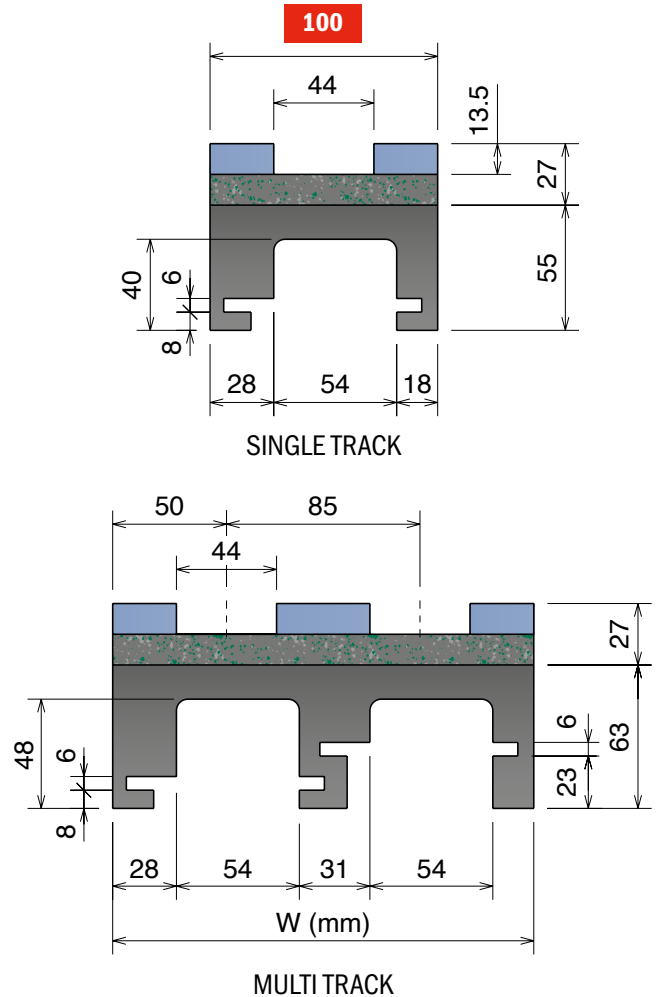

RS complete curve

α 90°	Tracks	W	Material
80216614RS	1	100	Standard codes are for RS
80216624RS	2	185	
80216634RS	3	270	
80216644RS	4	355	for RS^H
80216654RS	5	440	add "H"
80216664RS	6	525	for RS^C
80216674RS	7	610	add "C"
80216684RS	8	695	

Guides replacement kit

α 90°	Tracks	W	Material
80216614RS-KIT	1	100	Standard codes are for RS Kit
80216624RS-KIT	2	185	
80216634RS-KIT	3	270	
80216644RS-KIT	4	355	for RS^H Kit
80216654RS-KIT	5	440	replace "RS" with "RSH"
80216664RS-KIT	6	525	for RS^C Kit
80216674RS-KIT	7	610	replace "RS" with "RSC"
80216684RS-KIT	8	695	

MAGNETIC SYSTEM

Solid curve in different materials available on request.

Images may differ from the actual product and are for illustrative purposes only.

879-880-881 M42 Series

Chain Reference 879 M - K325 880 M - K325 880 M - K330 881 M - K325 881 M - K330

Curve Basic Width = 111 mm; Pitch = 85 mm

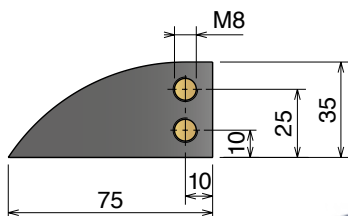
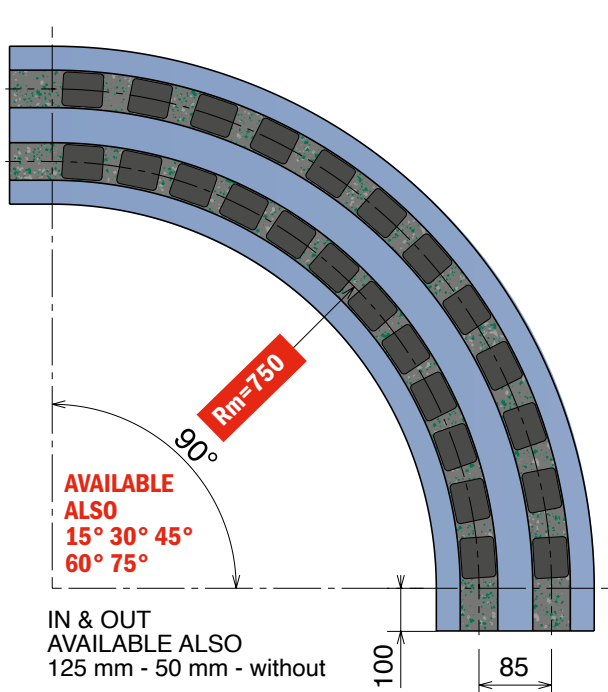

Available in **BluLub®**

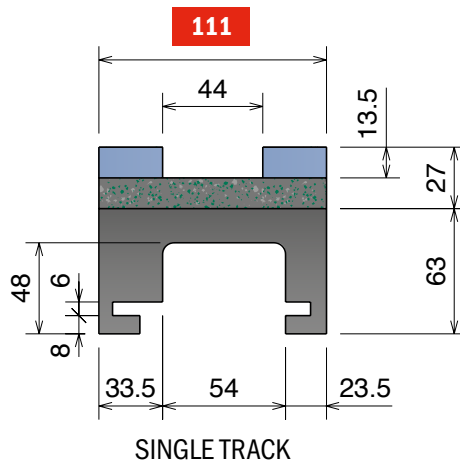

SINGLE TRACK

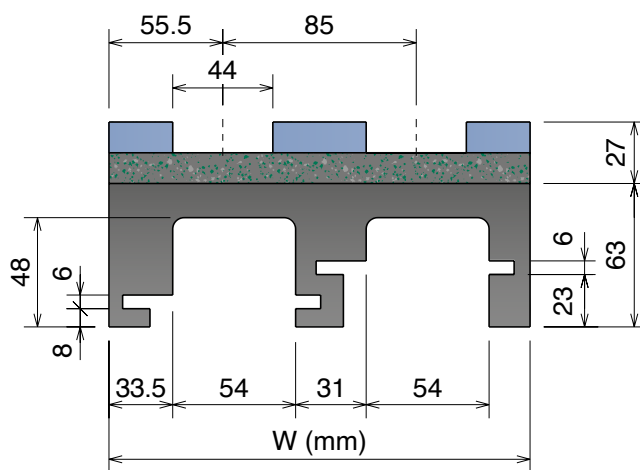

W (mm)
MULTI TRACK

RS complete curve

α 90°	Tracks	W	Material
81316614RS	1	111	Standard codes are for RS
81316624RS	2	196	
81316634RS	3	281	for RS^H
81316644RS	4	366	
81316654RS	5	451	for RS^C
81316664RS	6	536	
81316674RS	7	621	
81316684RS	8	706	

Guides replacement kit

α 90°	Tracks	W	Material
81316614RS-KIT	1	111	Standard codes are for RS Kit
81316624RS-KIT	2	196	
81316634RS-KIT	3	281	for RS^H Kit
81316644RS-KIT	4	366	
81316654RS-KIT	5	451	replace "RS" with " RS^H "
81316664RS-KIT	6	536	
81316674RS-KIT	7	621	
81316684RS-KIT	8	706	

MAGNETIC SYSTEM

Solid curve in different materials available on request.

879-880-881 M9 Series

Curve magnetic, Tab & Bevel / Magnetic, Tab & Bevel corner tracks / Kurvenführungen Magnet, Tab & Bevel Version

Materiale / Material / Materialien:
UHMW-PE riciclato / Recycling UHMW-PE
Rezykliertes UHMW-PE
BluLub Guide / Guides / Gleitprofile

879-880-881 M9 Series

Chain Reference 879 M - K325 880 M - K325 880 M - K330 881 M - K325 881 M - K330

Curve Basic Width = 110 mm; Pitch = 90 mm

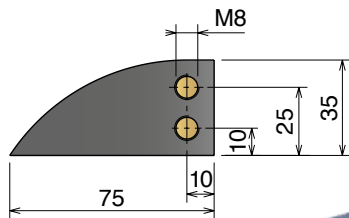
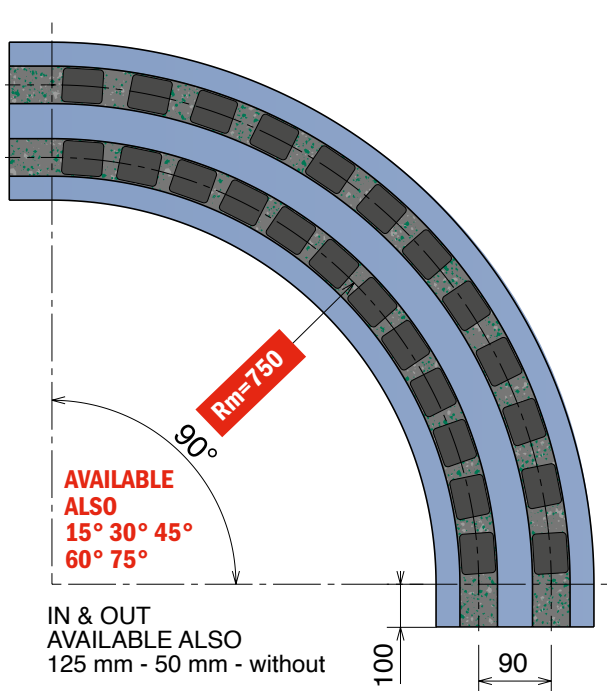

Available in
BluLub®

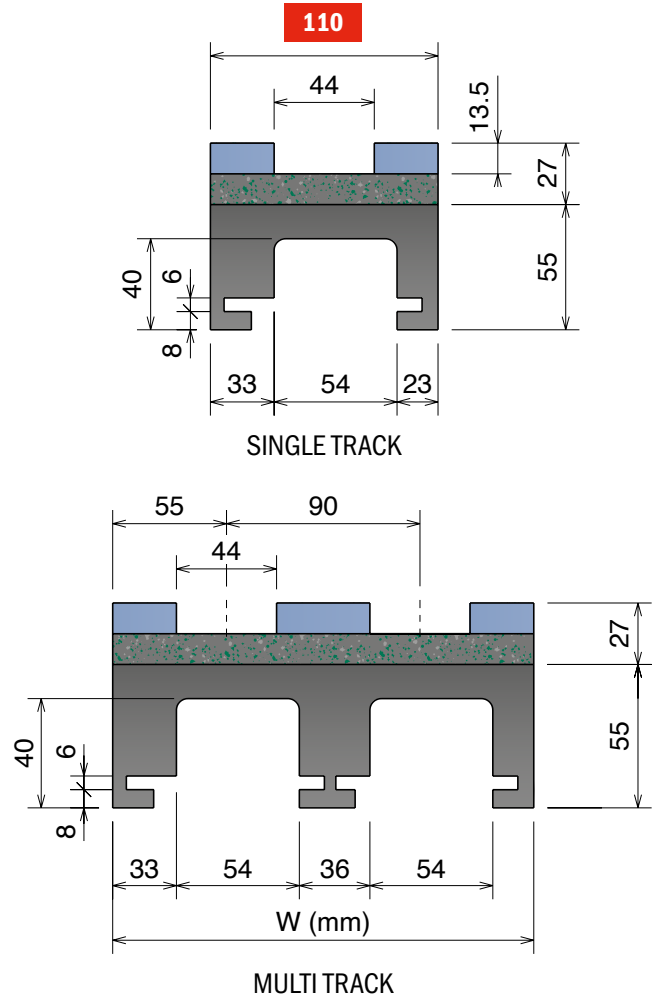

RS complete curve

α 90°	Tracks	W	Material
81416614RS	1	110	Standard codes are for RS
81416624RS	2	200	
81416634RS	3	290	for RS^H add "H"
81416644RS	4	380	
81416654RS	5	470	for RS^C add "C"
81416664RS	6	560	
81416674RS	7	650	
81416684RS	8	740	

Guides replacement kit

α 90°	Tracks	W	Material
81416614RS-KIT	1	110	Standard codes are for RS Kit
81416624RS-KIT	2	200	
81416634RS-KIT	3	290	for RS^H Kit replace "RS" with "RSH"
81416644RS-KIT	4	380	
81416654RS-KIT	5	470	for RS^C Kit replace "RS" with "RSC"
81416664RS-KIT	6	560	
81416674RS-KIT	7	650	
81416684RS-KIT	8	740	

MAGNETIC SYSTEM

Solid curve in different materials
available on request.

879-880-881 M43 Series

Chain Reference 879 M - K325 880 M - K325 880 M - K330 881 M - K325 881 M - K330 Delivery: **Easy** **Standard**

Curve Basic Width = 111 mm; Pitch = 85 mm

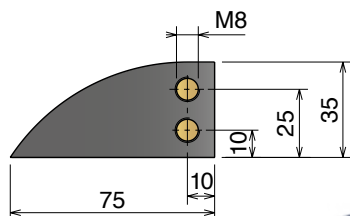
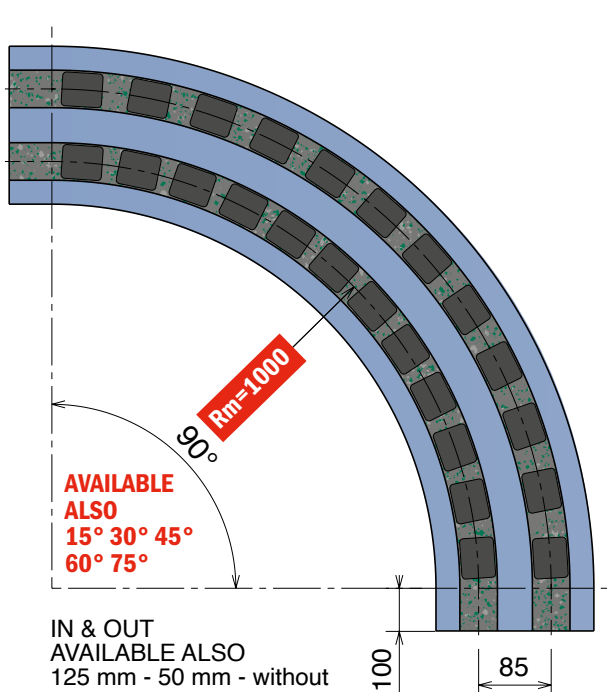

Available in
BluLub®

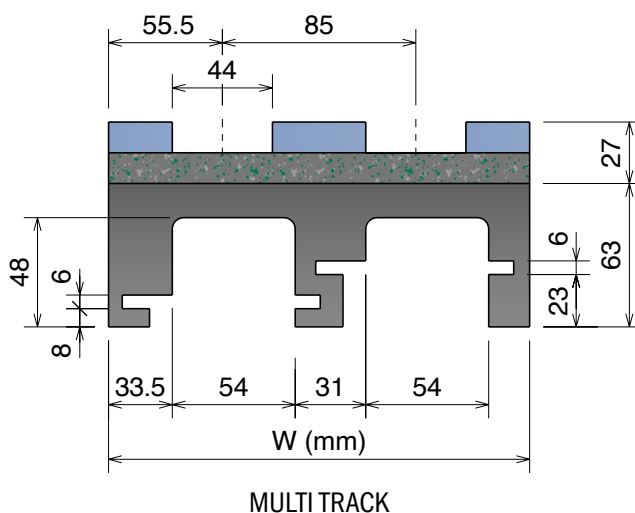
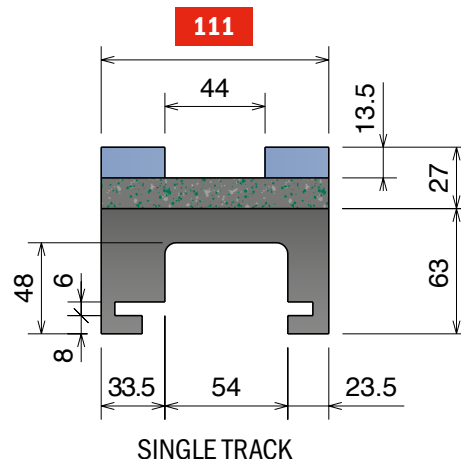

RS complete curve

α 90°	Tracks	W	Material
81219614RS	1	111	Standard codes are for RS
81219624RS	2	196	
81219634RS	3	281	for RS^H add "H"
81219644RS	4	366	
81219654RS	5	451	for RS^C add "C"
81219664RS	6	536	
81219674RS	7	621	
81219684RS	8	706	

Guides replacement kit

α 90°	Tracks	W	Material
81219614RS-KIT	1	111	Standard codes are for RS Kit
81219624RS-KIT	2	196	
81219634RS-KIT	3	281	for RS^H Kit replace "RS" with "RS ^H "
81219644RS-KIT	4	366	
81219654RS-KIT	5	451	for RS^C Kit replace "RS" with "RS ^C "
81219664RS-KIT	6	536	
81219674RS-KIT	7	621	
81219684RS-KIT	8	706	

MAGNETIC SYSTEM

Solid curve in different materials
 available on request.

879-880-881 M21A Series

Curve magnetic, Tab & Bevel / Magnetic, Tab & Bevel corner tracks / Kurvenführungen Magnet, Tab & Bevel Version

Materiale / Material / Materialien:
UHMW-PE riciclato / Recycling UHMW-PE
Rezykliertes UHMW-PE
BluLub Guide / Guides / Gleitprofile

879-880-881 M21A Series

Chain Reference 879 M - K450 880 M - K450 881 M - K450

Curve Basic Width = 129 mm; Pitch = 120 mm

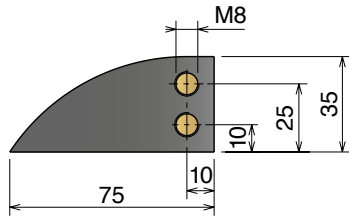
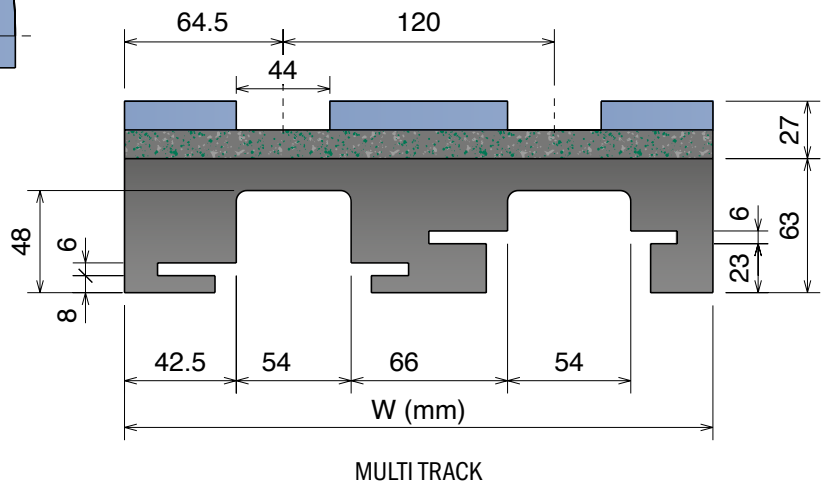
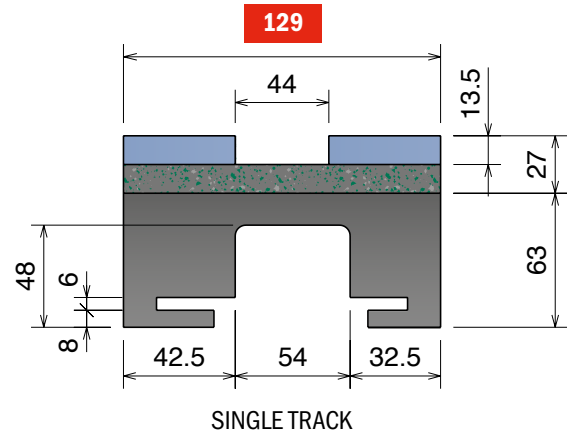
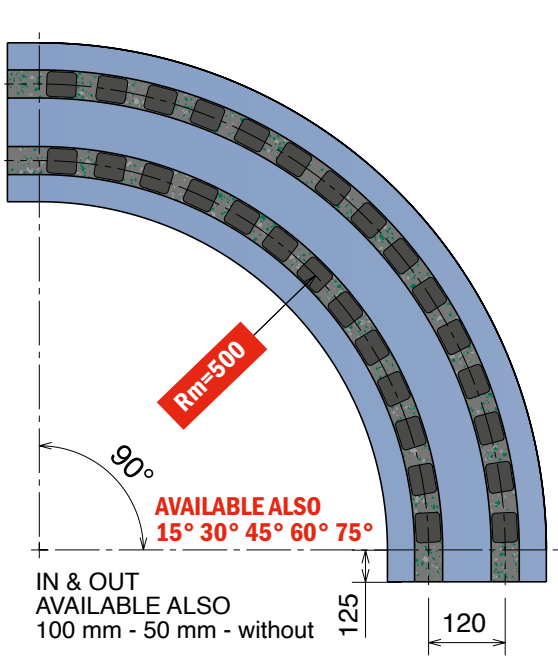

Available in
BluLub®

RS complete curve

α 90°	Tracks	W	Material
81511615RS	1	129	Standard codes are for RS
81511625RS	2	249	
81511635RS	3	369	for RS^H add "H"
81511645RS	4	489	
81511655RS	5	609	for RS^C add "C"

Guides replacement kit

α 90°	Tracks	W	Material
81511615RS-KIT	1	129	Standard codes are for RS Kit
81511625RS-KIT	2	249	
81511635RS-KIT	3	369	for RS^H Kit replace "RS" with "RSH"
81511645RS-KIT	4	489	
81511655RS-KIT	5	609	for RS^C Kit replace "RS" with "RSC"

MAGNETIC SYSTEM

Solid curve in different materials
available on request.

879-880-881 M22A Series

Chain Reference 879 M - K450 880 M - K450 881 M - K450

Curve Basic Width = 129 mm; Pitch = 120 mm

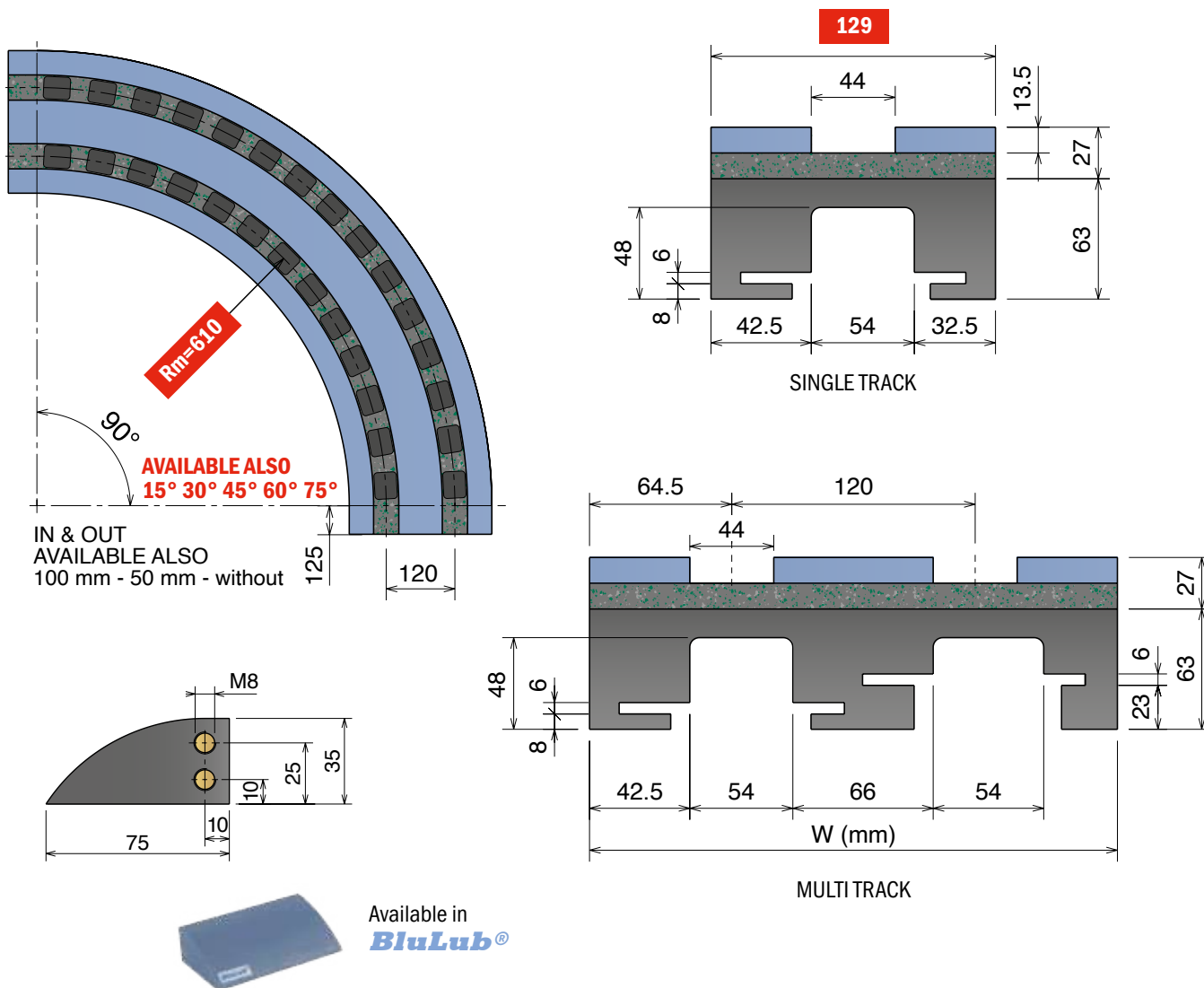

RS complete curve

α 90°	Tracks	W	Material
80413615RS	1	129	Standard codes are for RS
80413625RS	2	249	
80413635RS	3	369	for RS^H add "H"
80413645RS	4	489	
80413655RS	5	609	for RS^C add "C"

Guides replacement kit

α 90°	Tracks	W	Material
80413615RS-KIT	1	129	Standard codes are for RS Kit
80413625RS-KIT	2	249	
80413635RS-KIT	3	369	for RS^H Kit replace "RS" with "RS ^H "
80413645RS-KIT	4	489	
80413655RS-KIT	5	609	for RS^C Kit replace "RS" with "RS ^C "

MAGNETIC SYSTEM

Solid curve in different materials available on request.

879-880-881 M27 Series

Curve magnetic, Tab & Bevel / Magnetic, Tab & Bevel corner tracks / Kurvenführungen Magnet, Tab & Bevel Version

Materiale / Material / Materialien:
UHMW-PE riciclato / Recycling UHMW-PE
Rezykliertes UHMW-PE
BluLub Guide / Guides / Gleitprofile

879-880-881 M27 Series

Chain Reference 879 M - K450 880 M - K450 881 M - K450

Curve Basic Width = 129 mm; Pitch = 117 mm

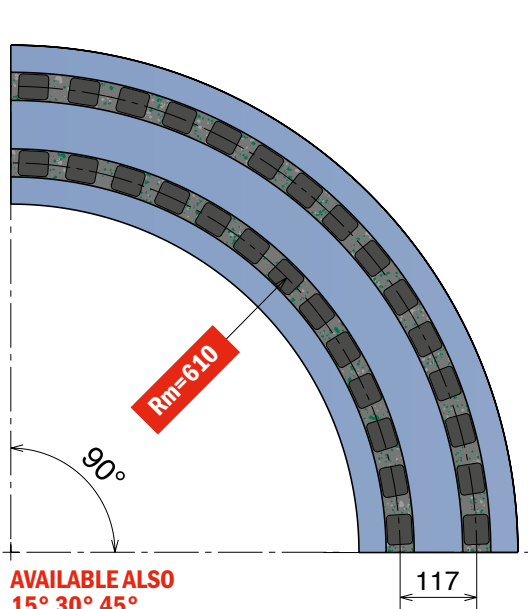

AVAILABLE ALSO
15° 30° 45°
60° 75°

IN & OUT
AVAILABLE ALSO
100 mm - 50 mm

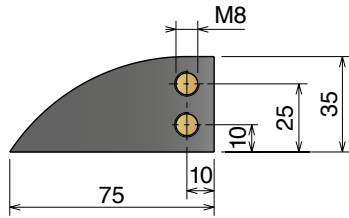

Available in
BluLub®

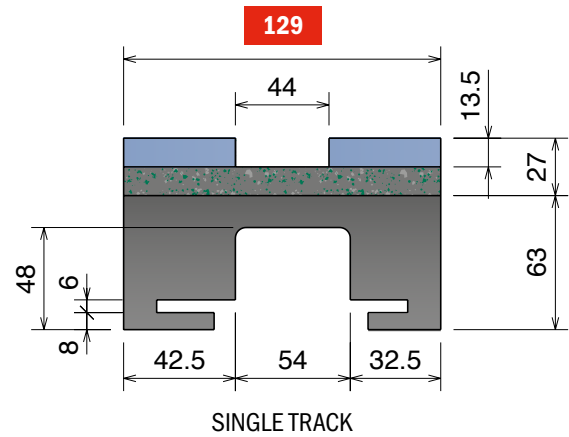

SINGLE TRACK

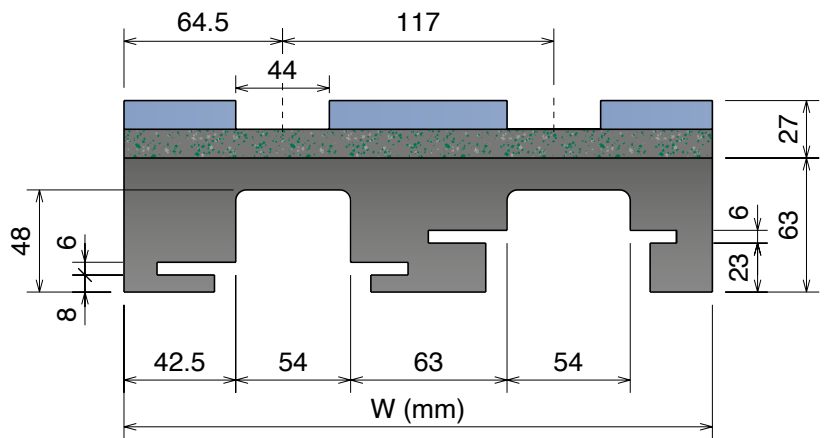

MULTI TRACK

RS complete curve

α 90°	Tracks	W	Material
83113610RS	1	129	Standard codes are for RS
83113620RS	2	246	
83113630RS	3	363	for RS^H add "H"
83113640RS	4	480	
83113650RS	5	597	for RS^C add "C"
83113660RS	6	714	
83113670RS	7	831	
83113680RS	8	948	

Guides replacement kit

α 90°	Tracks	W	Material
83113610RS-KIT	1	129	Standard codes are for RS Kit
83113620RS-KIT	2	246	
83113630RS-KIT	3	363	for RS^H Kit replace "RS" with "RSH"
83113640RS-KIT	4	480	
83113650RS-KIT	5	597	for RS^C Kit replace "RS" with "RSC"
83113660RS-KIT	6	714	
83113670RS-KIT	7	831	
83113680RS-KIT	8	948	

MAGNETIC SYSTEM

Solid curve in different materials
available on request.

Images may differ from the actual product and are for illustrative purposes only.

880-881 M61 Series

Chain Reference 880 M - K750 881 M - K750

Curve Basic Width = 214 mm; Pitch = 196 mm

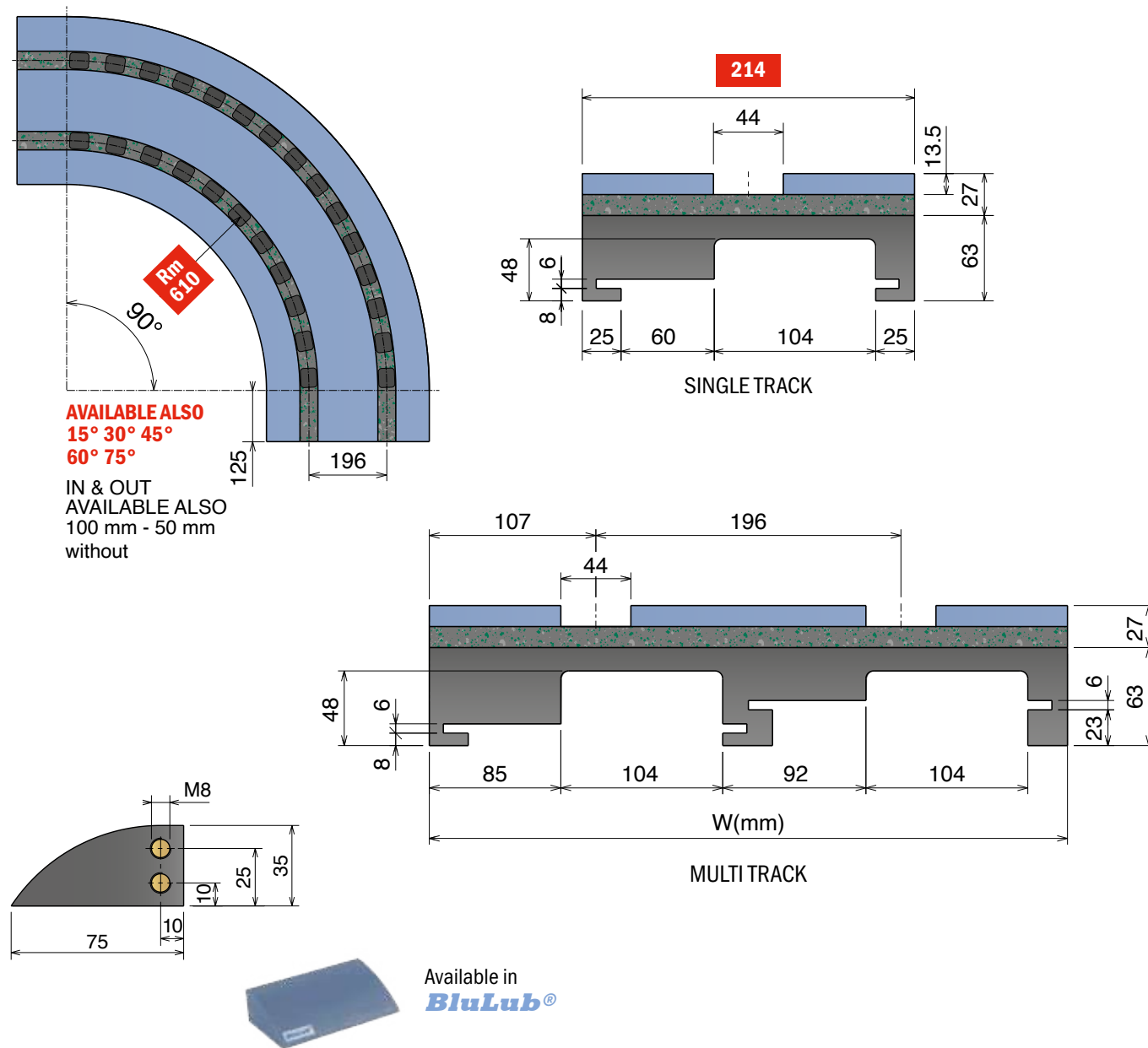

RS complete curve

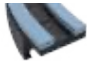
α 90°	Tracks	W	Material
81613615RS	1	214	 Standard codes are for RS for RS^H add "H" for RS^C add "C"
81613625RS	2	410	
81613635RS	3	606	

Guides replacement kit

α 90°	Tracks	W	Material
81613615RS-KIT	1	214	 Standard codes are for RS Kit for RS^H Kit replace "RS" with "RS ^H " for RS^C Kit replace "RS" with "RS ^C "
81613625RS-KIT	2	410	
81613635RS-KIT	3	606	

MAGNETIC SYSTEM

Solid curve in different materials
 available on request.

880-881 M62/66/65 Series

Curve magnetiche, Tab & Bevel / Magnetic, Tab & Bevel corner tracks / Kurvenführungen Magnet, Tab & Bevel Version

Materiale / Material / Materialien:
UHMW-PE riciclato / Recycling UHMW-PE
Rezykliertes UHMW-PE
BluLub Guide / Guides / Gleitprofile

880-881 M62/66/65 Series

Chain Reference	880 M - K750	881 M - K750
-----------------	--------------	--------------

Curve Basic Width = 214 mm

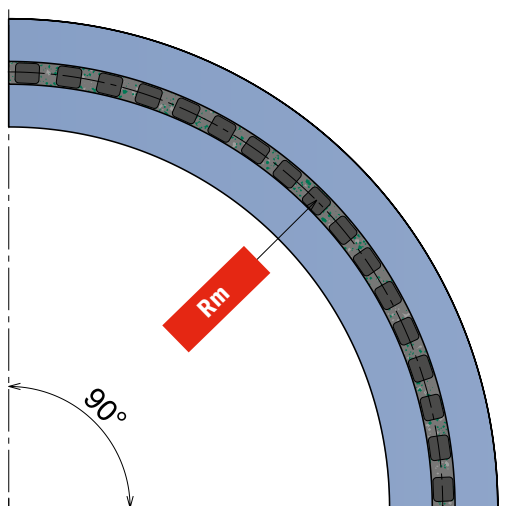

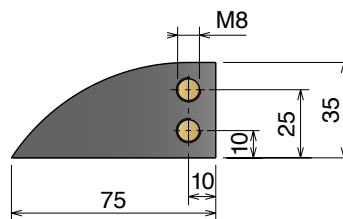
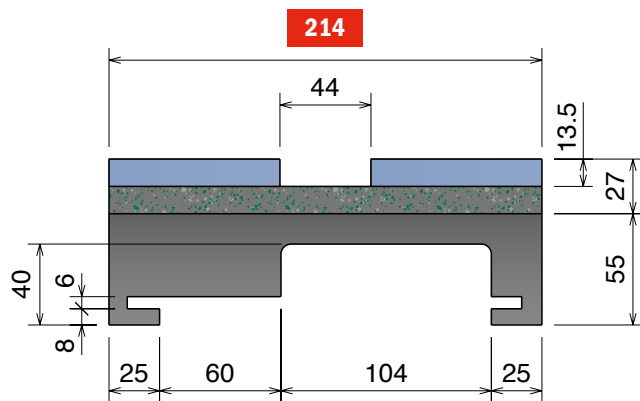

AVAILABLE ALSO
15° 30° 45°
60° 75°

IN & OUT
AVAILABLE ALSO
125 mm - 100 mm
50 mm





Available in
BluLub®

RS complete curve

α 90°	Tracks	W	Rm	Material
80716610RS	1	214	750	 Standard codes are for RS
80718610RS	1	214	860	
80719610RS	1	214	1000	
				 for RS^H add " H "
				 for RS^C add " C "

Guides replacement kit

α 90°	Tracks	W	Rm	Material
80716610RS-KIT	1	214	750	 Standard codes are for RS Kit
80718610RS-KIT	1	214	860	
80719610RS-KIT	1	214	1000	
				 for RS^H Kit replace " RS " with " RS^H "
				 for RS^C Kit replace " RS " with " RS^C "

MAGNETIC SYSTEM

Solid curve in different materials
available on request.